

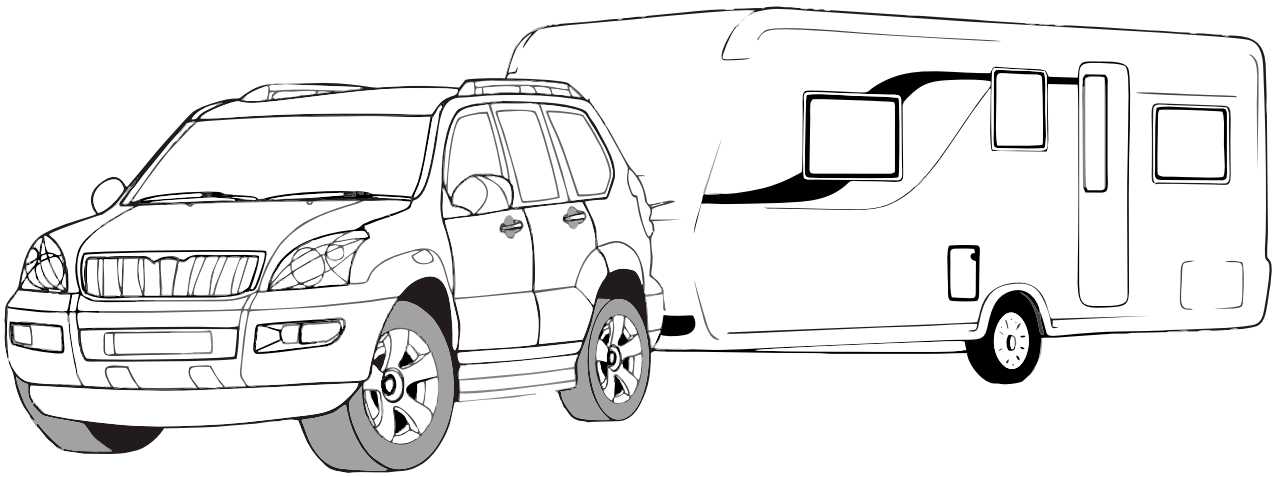

13-



!

- 1.
- 2.

3.

4.

!

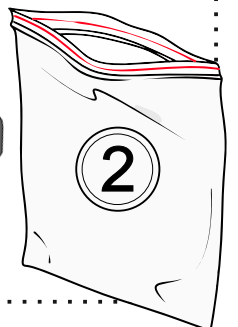
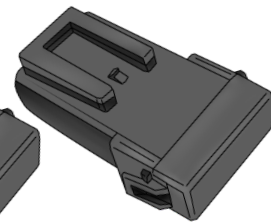
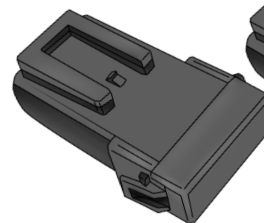
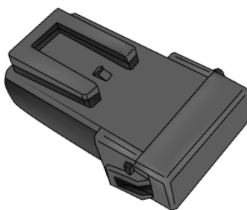
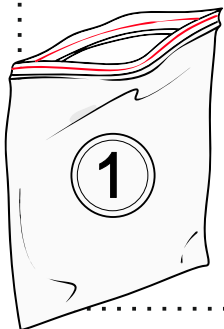
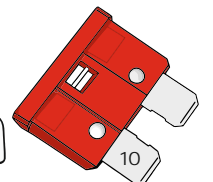
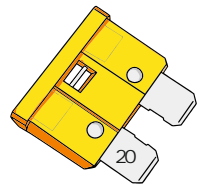
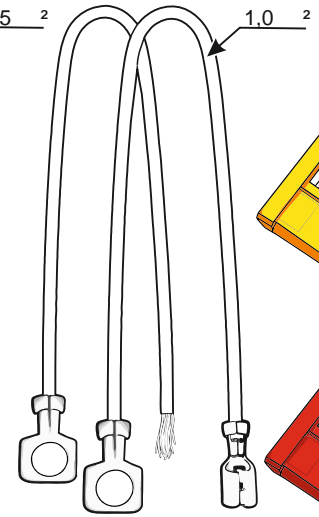
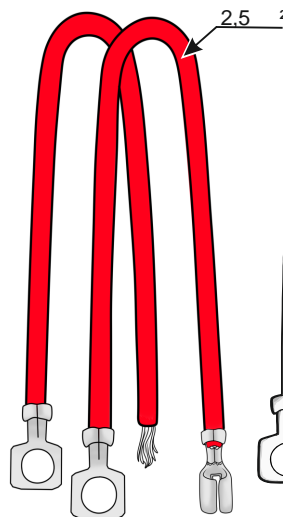
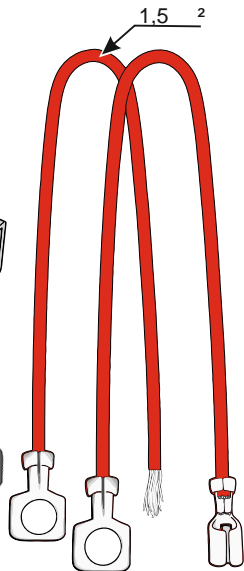
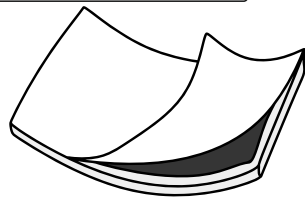
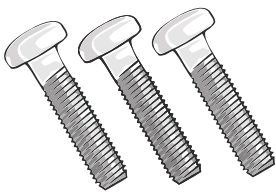
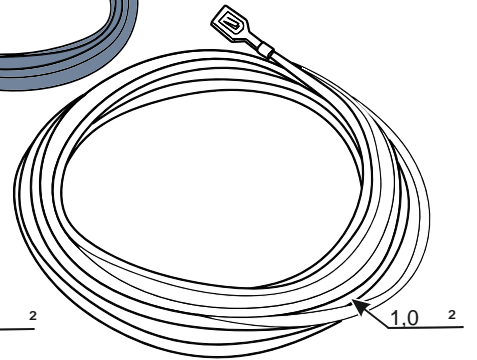
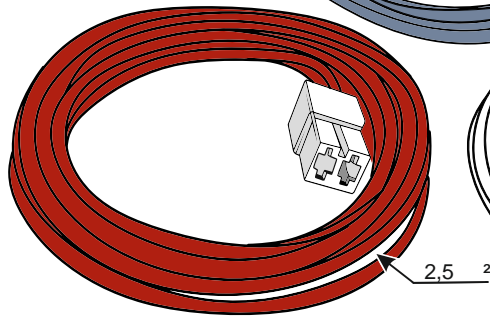
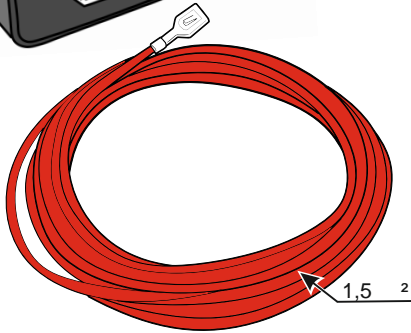
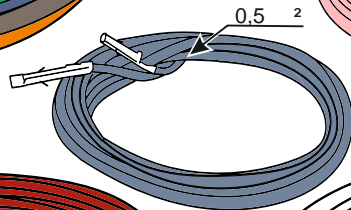
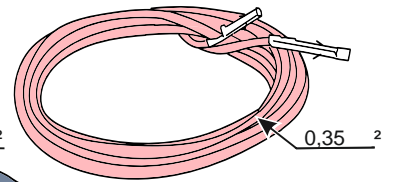
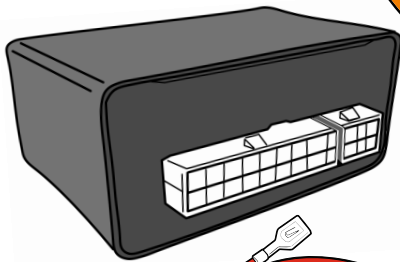
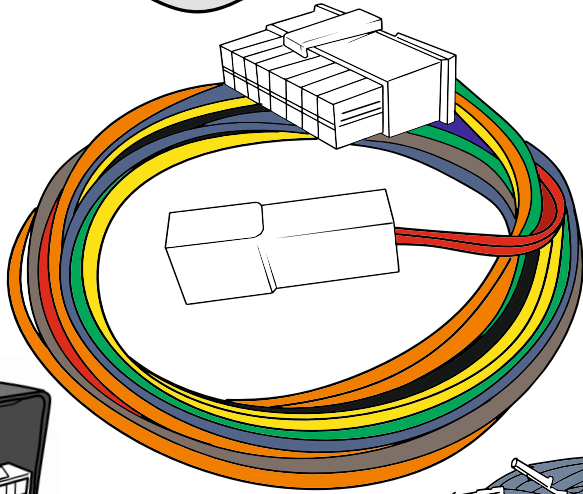
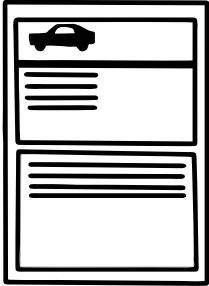
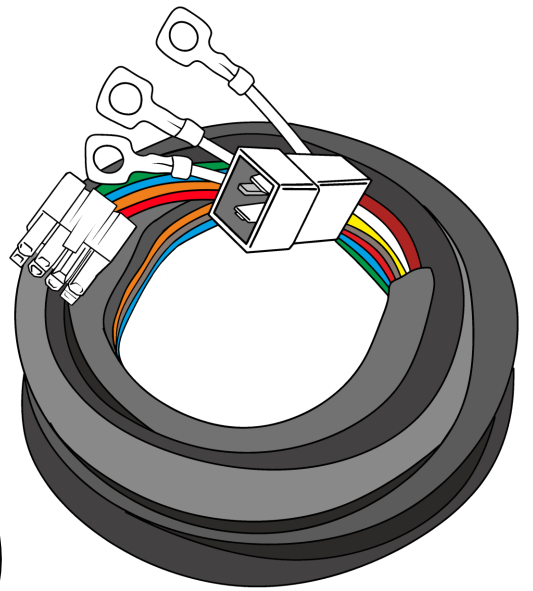
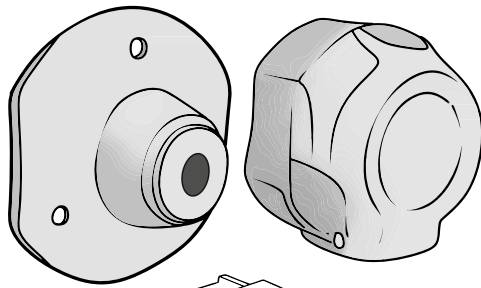
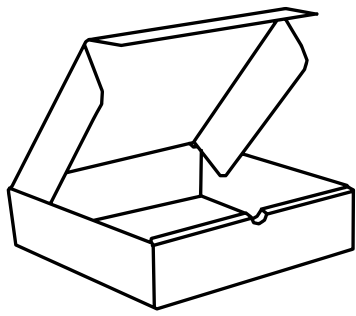

13 PIN

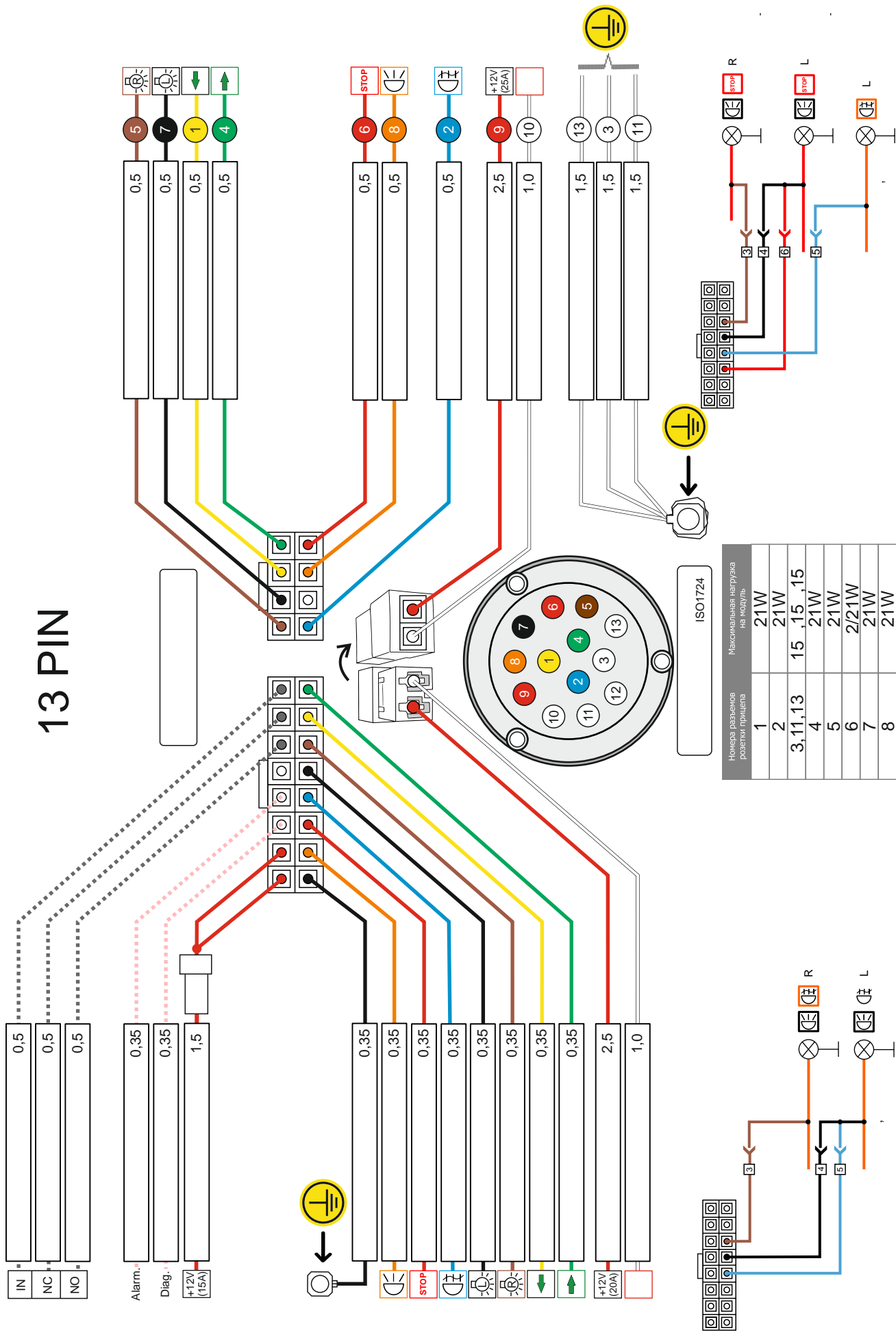

Номера разъемов розетки прицепа	Максимальная нагрузка на кабель
1	21W
2	21W
3,11,13	15, 15, 15
4	21W
5	21W
6	2/21W
7	21W
8	21W
9	21W
10	25

NO

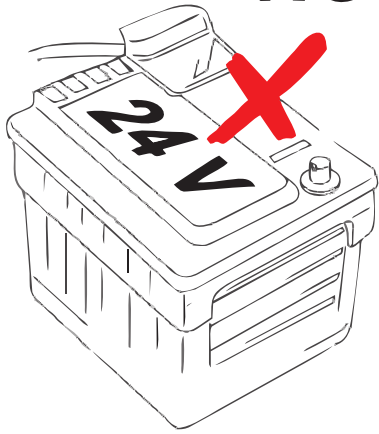

OK

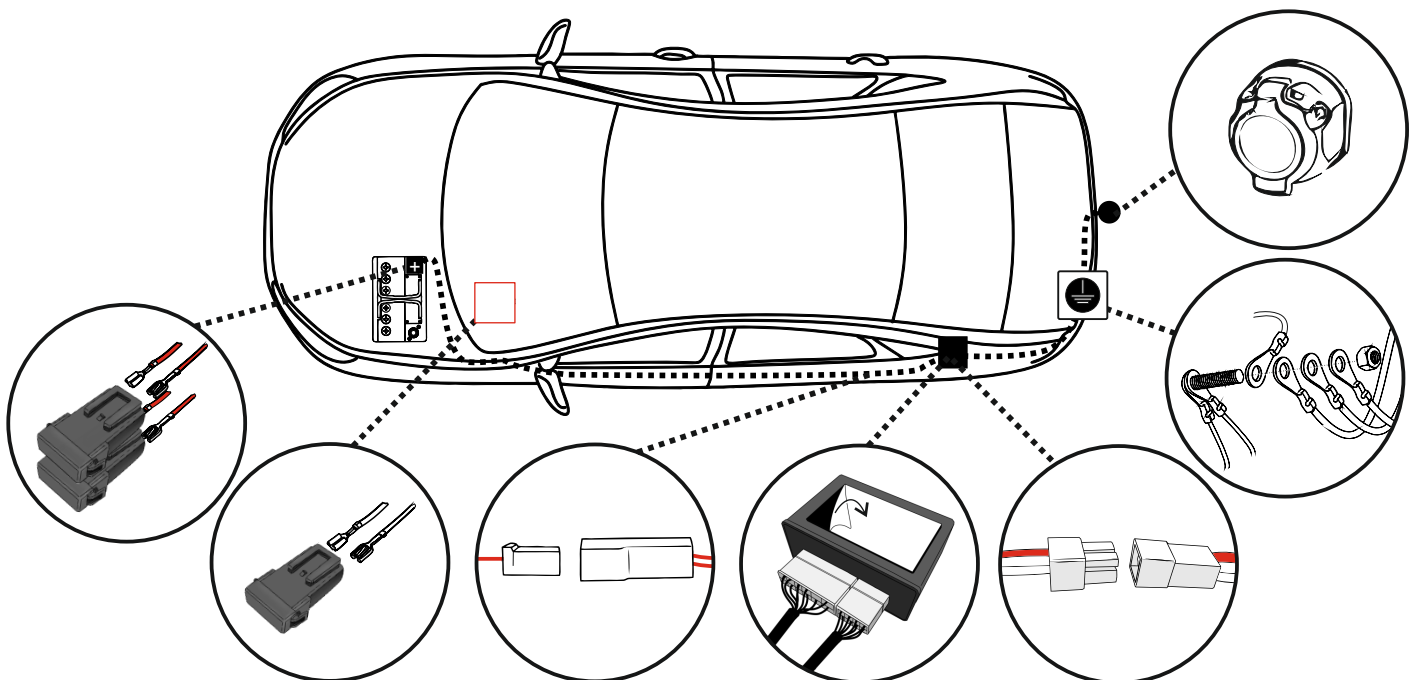
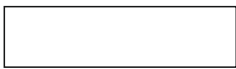
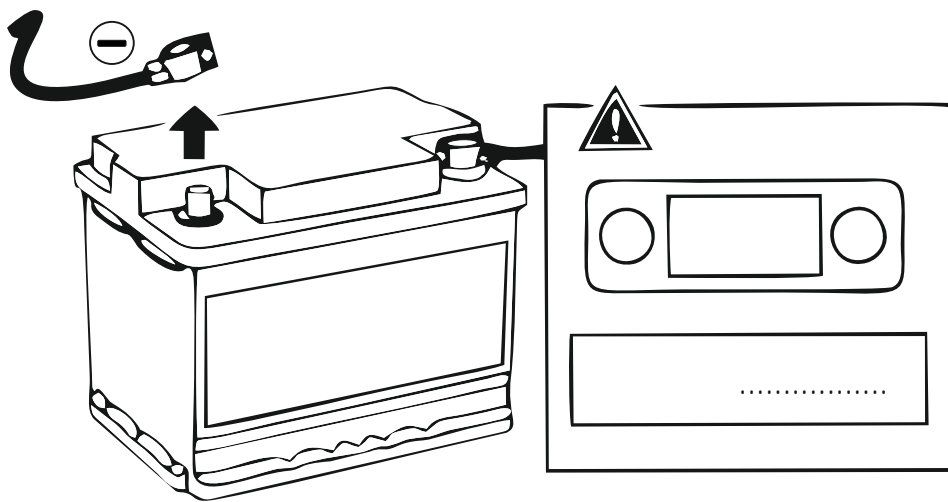
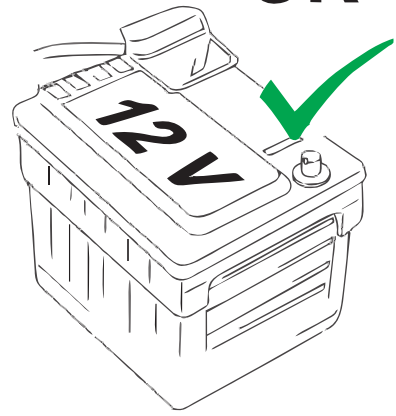

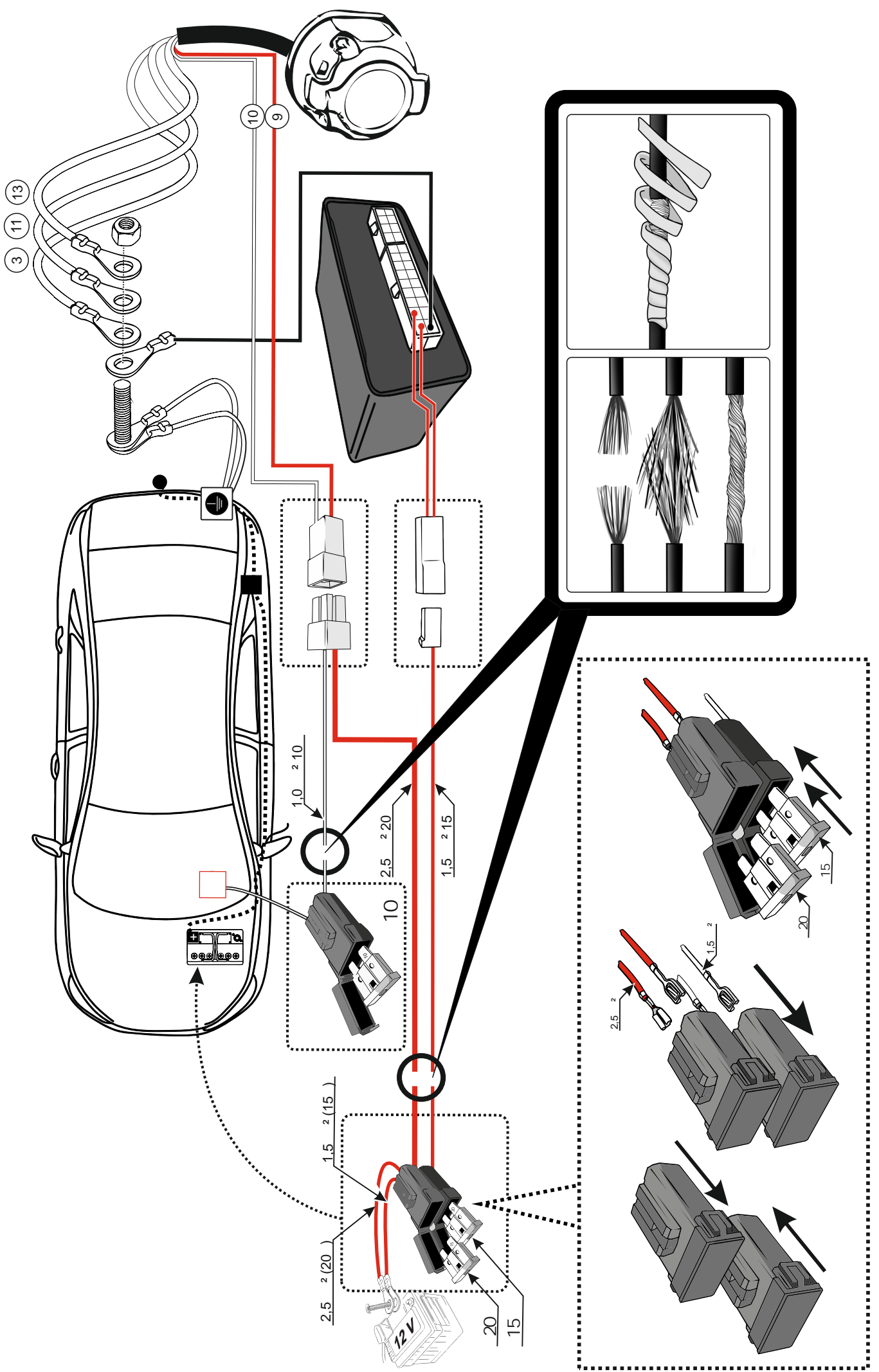

2

1

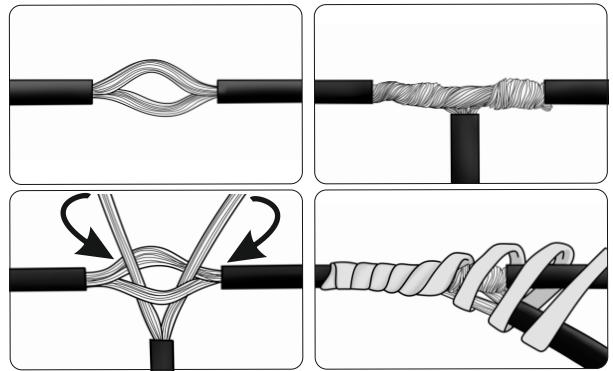
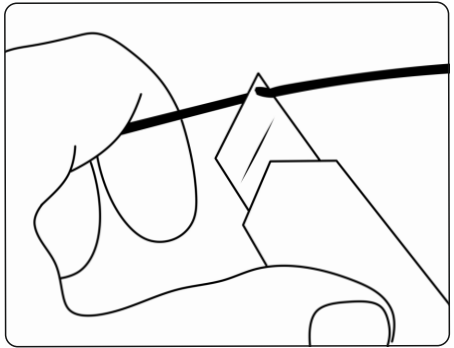
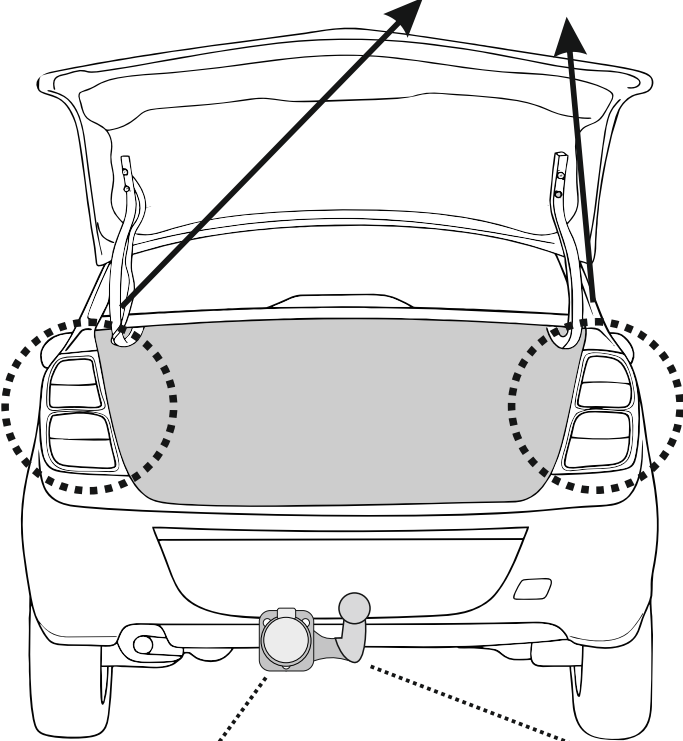
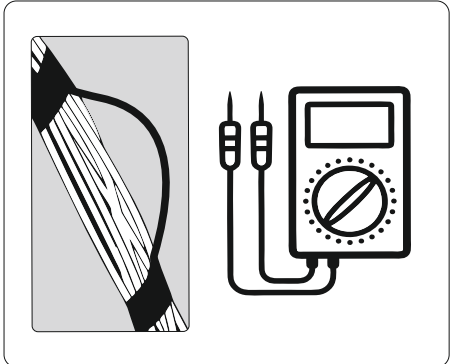
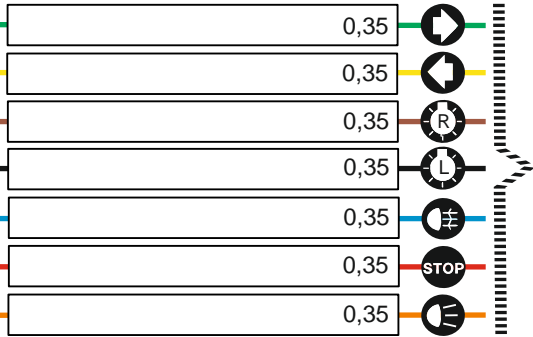
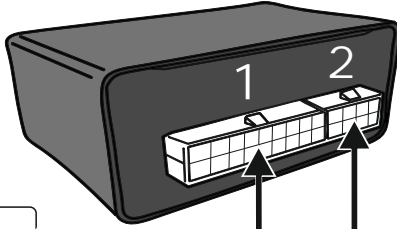
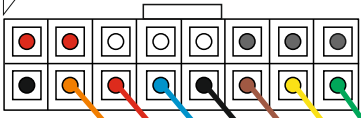

2

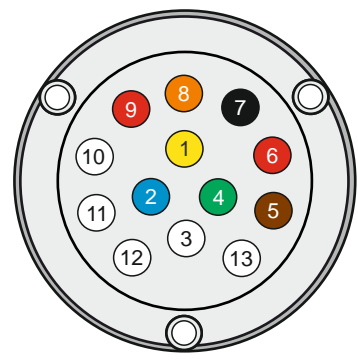
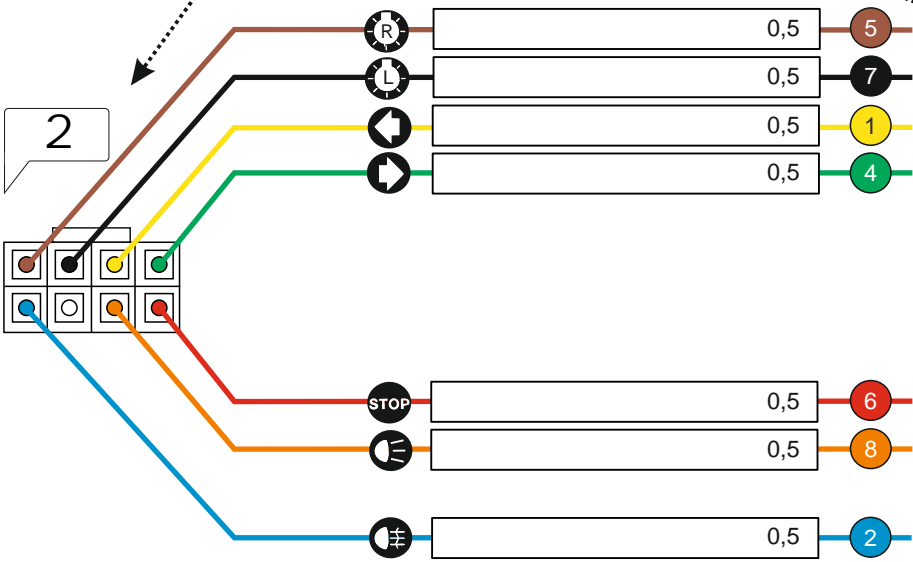

ISO1724



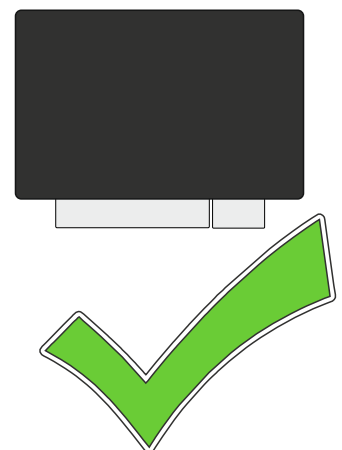
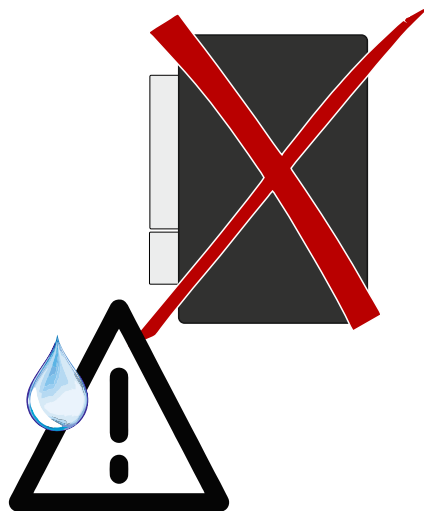
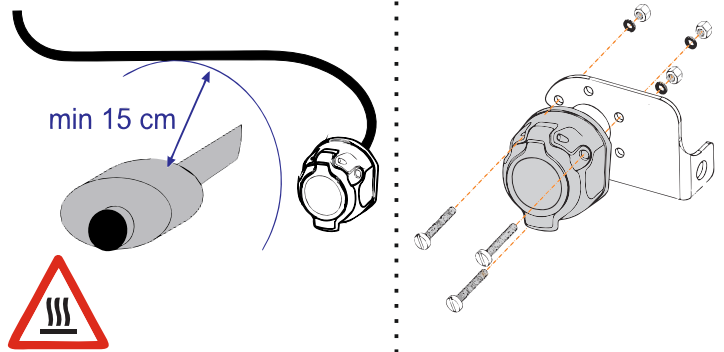
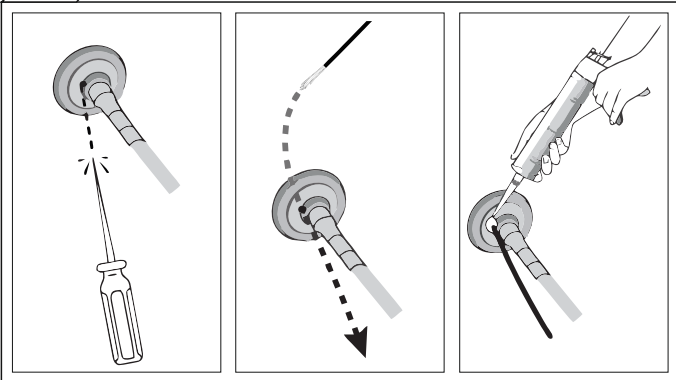
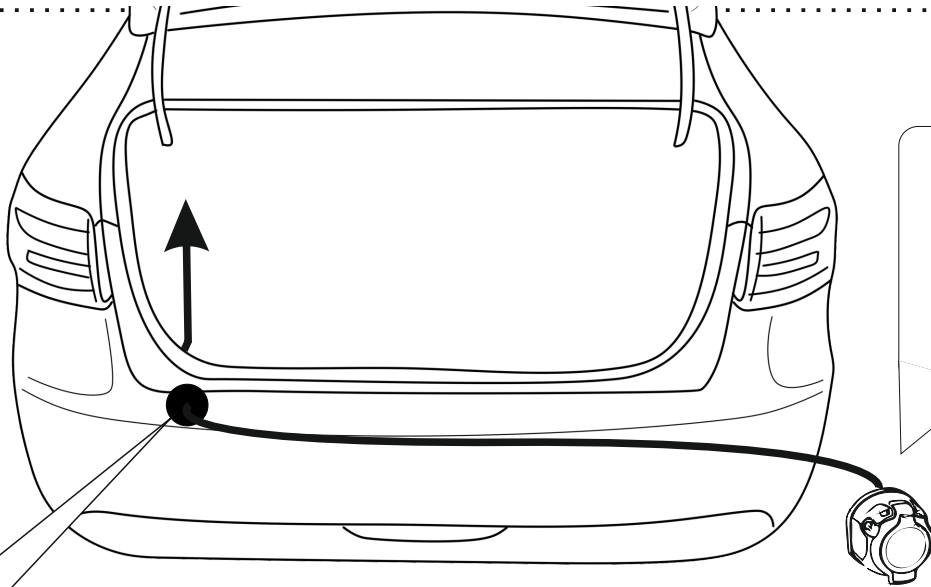
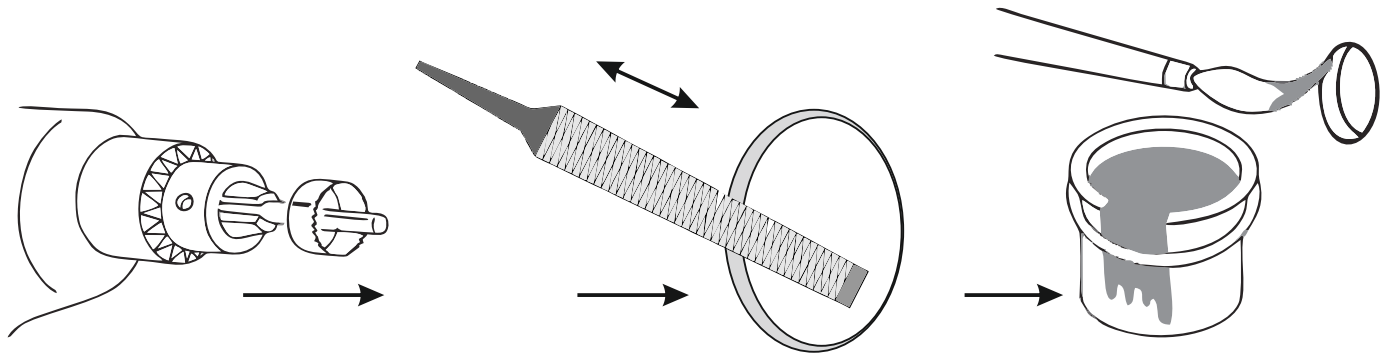

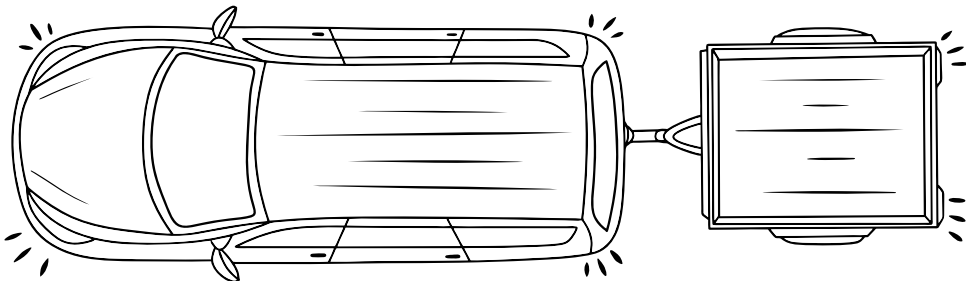
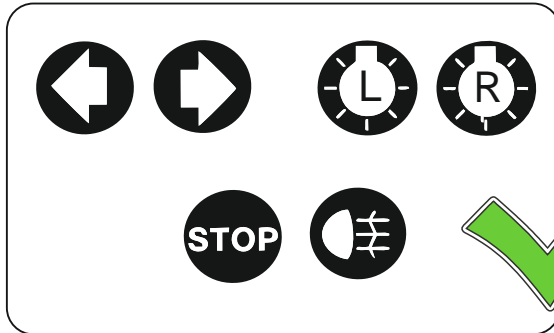
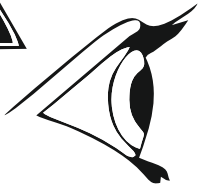
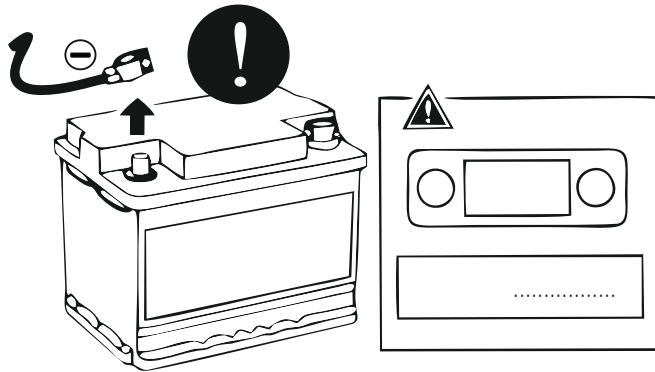
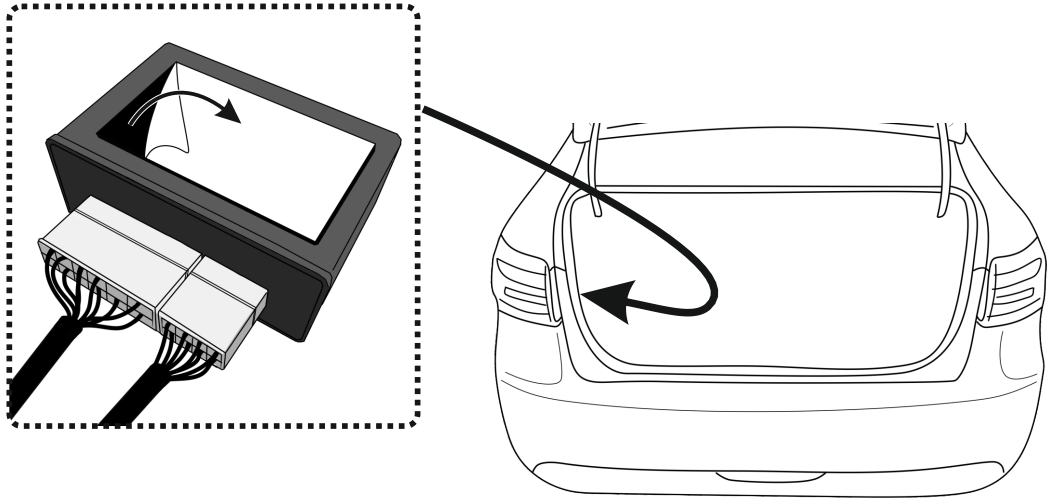

Smart-connect KA.SC.7.2 (-)

(-) (ISO1724),

12

(9 15),

. .)

9-15

-45 +55 °C.

« »

0,0025

18.

(/ /)

78/50/25

1,2.

1,2.

0,001 (

: 5W

0,5).

LED

:

BSI (

)

CAN-BUS (

)

Check-Control (

)

PDC (

)

:

1.

2.

3.

4.

6,

!

15

()

15

24

7

(. .):

- 1.
- 2.
- 3.

BSI ()

4 5

(PDC)

PDC

(IN- NC)

, NO

IN- N

, NC



PDC,

1. 2.1. PDC (+12 V).
2. 2.2. PDC,
3. 2.3. PDC

PDC,

*

PDC,

*

PDC

**

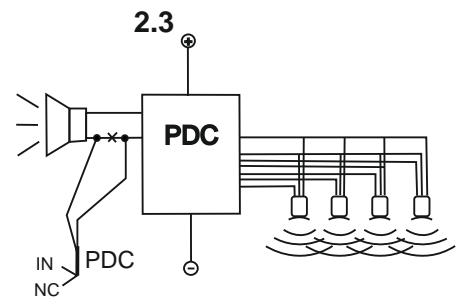
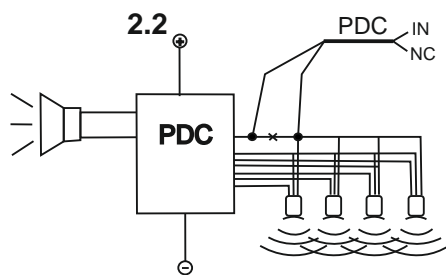
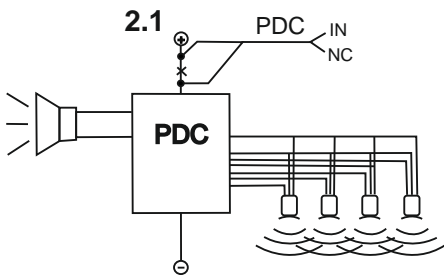

PDC

PDC

*

**

(Alarm.)

13 16-

(1, 13)

« », 1

(Diag.)

« » +12

15 30)

(

« »

14 16-

1

(:).

.....	1	.
.....	7	.
.....	1	.
.....	1	.
.....	2	.
.....	1	.

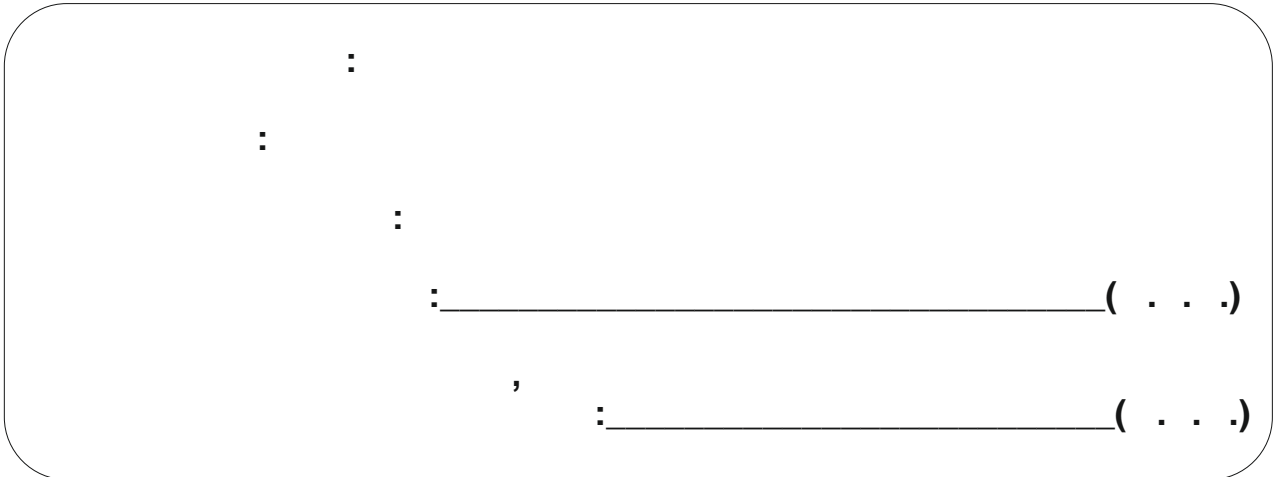

« », .